

Pressure Switch



規格說明 SPECIFICATION

工作介質 Medium	礦物油 Mineral Oil
工作溫度 Temp.Range(°C)	-20°C ~ +80°C
重現性 Repetition Accuracy	±1%
最大耐壓 Max. Overpressure	600 kgf/cm ²
黏度範圍 Viscosity Range(cst)	10~800 cst
切換頻率 Change Over Frequency	60 operations/min (每分鐘60次)
觸點負載 Contaction load	250 VAC (交流) 3A (安培) 30 VDC (直流) 4A (安培)
保護規範 Protection	IP65 DIN40050
重量 Weight(Kgs)	0.75kg (公斤)

型號說明 HOW TO ORDER

JPS - 35 - 1 - 10

旋轉型式 KNOB TYPE

10 : 內六角螺桿調整

INNER HEXANGULAR BOLT ROD ADJUST

20 : 把手旋鈕螺桿調整

HAFT TURNING KNOB BOLT ROD ADJUST

閥規格 VALVE SIZE

1 : 1/4" PT 2 : 1/4" NPT

3 : 1/4" SAE 4 : 1/4" BSP

調壓範圍 PRESSURE ADJUSTING RANGE

35 : 5~35 kgf/cm² (71~500PSI)

70 : 10~70 kgf/cm² (140~1000PSI)

150 : 30~150 kgf/cm² (420~2200PSI)

230 : 50~230 kgf/cm² (700~3300PSI)

420 : 90~420 kgf/cm² (1300~6000PSI)

系列編號 SERIES NUMBER

曲線圖 DIAGRAM

● JPS-35

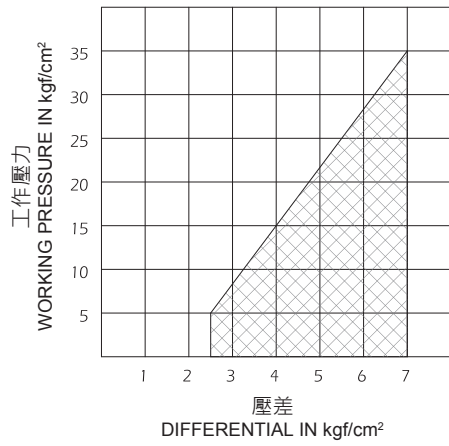

● JPS-70

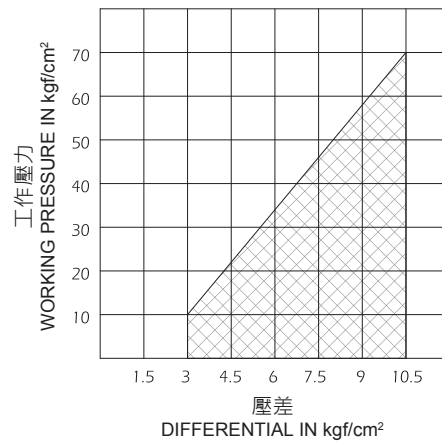

● JPS-150

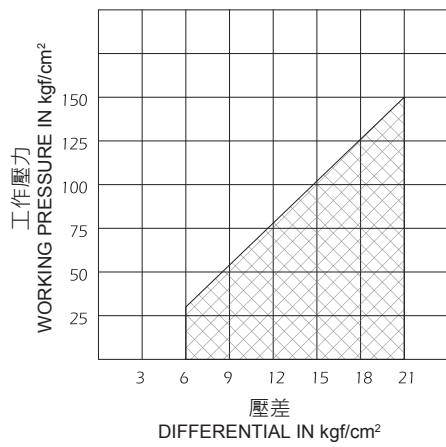

● JPS-230

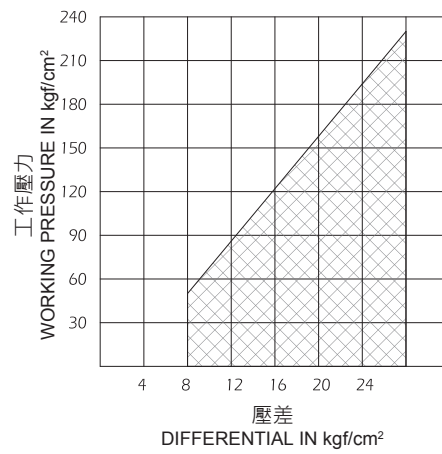

● JPS-420

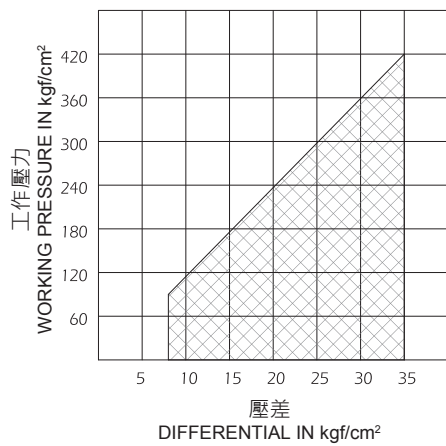

安裝尺寸 INSTALLATION DIMENSIONS

JPS-~~×~~-10

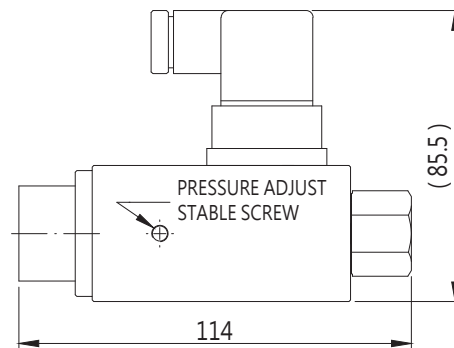
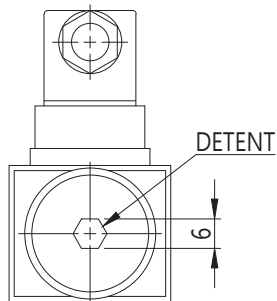
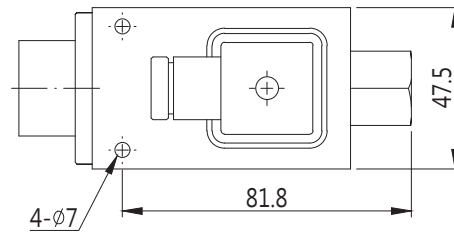

JPS-~~×~~-20

